

# Becatech

Interconnective Power



## Bimetallic terminals (cable lug AL/CU)

### Technical Specification :

Surface: bright.

Material:

- E-aluminum.
- Copper.

Characteristics:

- For connecting non-tensioned aluminum conductors to copper connections in humid environments and outdoors.
- Barrier design with oil stop and solid copper palm.
- With crimp markings for correct crimp positioning.
- Internal chamfer for simple cable insertion.

Additional information: RE = round solid wire, RM = round multi-stranded, SE = sector shaped single solid wire, SM = sector shaped multi-stranded, sector shaped conductors must be pre-rounded.

### Drawing :

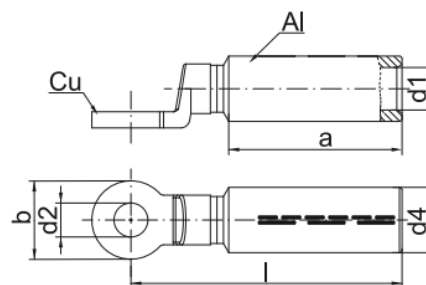

Becatech B.V.  
Middenweg 18  
3930 Hamont-Achel

info@becatech.be  
www.becatech.be  
+32 (0)11 19 29 45

IBAN BE89363217265185  
VAT BE0777.903.079  
CoC 0777.903.079

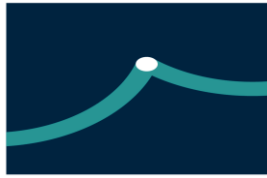

# Becatech

Interconnective Power

Cross section mm <sup>2</sup>		Size Of Bolt Diam.	Dimension mm						Cu Weight /100st. (kg)	Weight /100st. (kg)
			a	b	d1	d2	d4	l		
RM/SM	RE/SE									
16	25	M8	34	24	6.0	8.5	12	68	4.4	5.9
16	25	M10	34	24	6.0	10.5	12	68	4.2	5.7
25	35	M8	34	24	6.8	8.5	12	68	4.4	5.8
25	35	M10	34	24	6.8	10.5	12	68	4.2	5.6
25	35	M12	34	24	6.8	13.0	12	68	3.9	5.3
35	50	M8	43	24	8.0	8.5	14	77	4.4	6.3
35	50	M10	43	24	8.0	10.5	14	77	4.2	6.1
35	50	M12	43	24	8.0	13.0	14	77	3.8	5.8
50	70	M8	43	25	9.8	8.5	16	77	4.4	6.4
50	70	M10	43	25	9.8	10.5	16	77	4.2	6.2
50	70	M12	43	25	9.8	13.0	16	77	3.9	5.9
70	95	M8	52	25	11.2	8.5	18.5	84.5	3.9	6.9
70	95	M10	50	25	11.2	10.5	18.5	85	4.2	7.4
70	95	M12	50	25	11.2	13.0	18.5	85	3.9	7.1
95	120	M8	56	30	13.2	8.5	22	90.5	4.1	8.0
95	120	M10	50.5	30	13.2	10.5	22	90.5	7.4	11.4
95	120	M12	50.5	30	13.2	13.0	22	90.5	6.8	10.8
95	120	M16	50.5	30	13.2	17.0	22	90.5	6.4	10.4
120	150	M8	50.5	30	14.7	8.5	23	95	3.9	8.3
120	150	M12	50.5	30	14.7	13.0	23	92.0	6.8	11.4
120	150	M16	50.5	30	14.7	17.0	23	92.0	6.4	10.8
150	185	M12	62	30	16.3	13.0	25	104.0	6.8	13.1
150	185	M16	62	30	16.3	17.0	25	104.0	6.4	12.7
185	240	M10	62	30	18.3	10.5	28.5	105.5	10.3	18.6
185	240	M12	62	35	18.3	13.0	28.5	105.5	10.1	18.4
185	240	M16	62	35	18.3	17.0	28.5	105.5	9.3	17.6
185	240	M20	60	35	18.3	21.0	28.5	107.5	10.1	18.4
240	300	M10	70	35	21.0	10.5	32	118.5	12.1	22.5
240	300	M12	70	35	21.0	13.0	32	118.5	11.8	22.2
240	300	M16	70	35	21.0	17.0	32	118.5	11.0	21.4
240	300	M20	70	35	21.0	21.0	32	118.5	10.1	20.5
300	-	M12	70	36	23.3	13.0	34	123.5	17.7	33.7
300	-	M16	70	36	23.3	17.0	34	123.5	16.9	32.9
300	-	M20	70	40	23.3	21.0	34	123.5	16.0	32.0
400	-	M12	73	40	26.0	13.0	38.5	150.5	25.6	37.4

Becatech B.V.  
Middenweg 18  
3930 Hamont-Achel

info@becatech.be  
www.becatech.be  
+32 (0)11 19 29 45

IBAN BE89363217265185  
VAT BE0777.903.079  
CoC 0777.903.079